

**PARTS LIST
MODEL H3340**

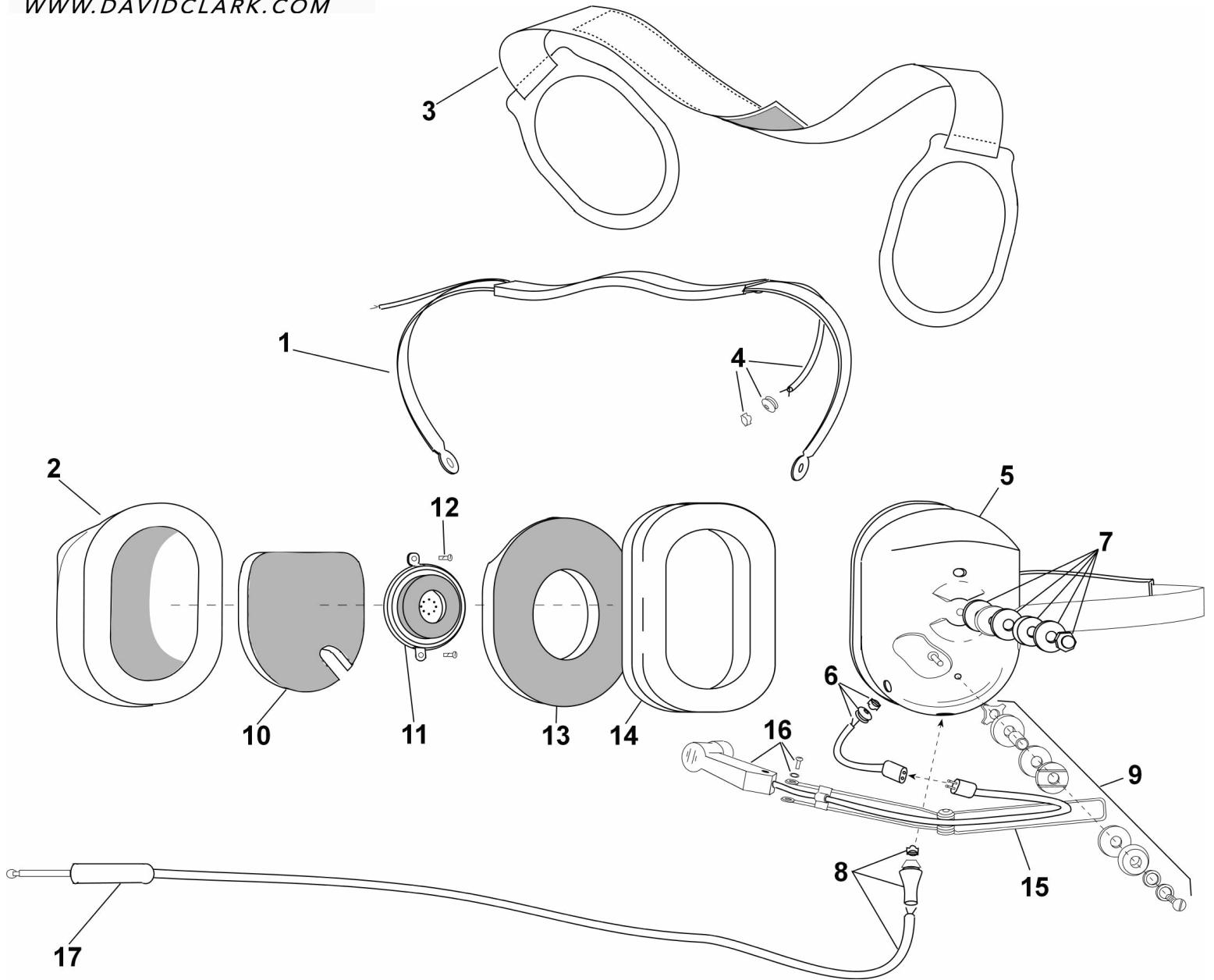

No.	Description	Part No.
1	Spring Assembly	10117G-97
2	Dome, Right	15522P-03
3	Adjustable Strap	10370G-03
4	Overhead Cord Kit	22607G-01
5	Left Dome	15522P-07
6	Mic Jack Cord Kit	10405G-05
7	Nut and Washer Kit (10 pk)	12052G-02
8	Comm Cord Assy Kit	18028G-09
9	Boom Guide Kit	12840G-01

No.	Description	Part No.
10	Dome Filter	11410P-02
11	Earphone Assembly	10376G-17
12	Screw (10/pk)	00023M-07
13	Filter	25629P-05
14	Earseal (pair)	18316G-02
15	Microphone Boom Assy	12765G-04
16	M-1/DC Microphone	12948G-01
17	Conn, Elec-Modified	14120P-05

ELECTRICAL SCHEMATIC
MODEL H3340

